

EUROPOWER cells are made in **AGM technology**. Owing their excellent power and current capability these batteries are designed for both large and important central battery UPS systems as well as for applications in telecommunications and renewable energy engineering (the battery system **capacity even up to 12000 Ah**). They have a very high repeatability of parameters and long designed life.



TECHNICAL DATA

| | | |
|---|---|----------------------|
| Nominal voltage | 2 V | |
| Nominal capacity | 1500 Ah / C ₁₀ | |
| Cell per unit | 1 | |
| Technology | AGM | |
| Design life | over 17 years @ 20°C* over 15 years @ 25°C | |
| Dimensions | height | 369,0 mm |
| | length | 400,0 mm |
| | width | 350,0 mm |
| Weight | ~128,0 kg | |
| | Capacity @ 25°C | |
| Capacity @ 25°C | 20h 75,74A @1,85V/cell. | 1514,8 Ah |
| | 8h 181,5A @1,80V/cell. | 1452,0 Ah |
| | 5h 270,0A @1,75V/cell. | 1350,0 Ah |
| | 1h 909,0A @1,75V/cell. | 909,0 Ah |
| Ambient nominal temperature range | charge | 0°C ~ 40°C |
| | discharge | -20°C ~ 50°C |
| | storage | -20°C ~ 40°C |
| Internal resistance | @ fully charge battery | ≤0,4 mΩ |
| Charging voltage @ 20°C | standby use | 2,25 V (-3 mV/°C) |
| | cycle use | 2,35 V (-4 mV/°C) |
| Charging current | recommended | 150 A |
| | maximum | 375 A |
| Maximum discharge current (for 5 sec) | 6000 A | |
| Capacity retention during storage @ 20°C (self discharge) | after 1 month | 97 % |
| | after 6 months | 81 % |
| | after 12 months | 64 % |
| Container material | standard | ABS UL 94-HB |
| | optional | ABS UL 94-V0** |
| Terminal | bolt fastened | B6 |
| Terminal hardware initial torque | 10,0 Nm | |

* - According to Eurobat (Long Life group)

** - Flame-retardant

APPLICATIONS

- high power Uninterruptible Power Supplies (UPS)
- substations
- emergency lighting systems
- telecommunication power plants
- renewable power sources
- GSM base stations

DIMENSIONS

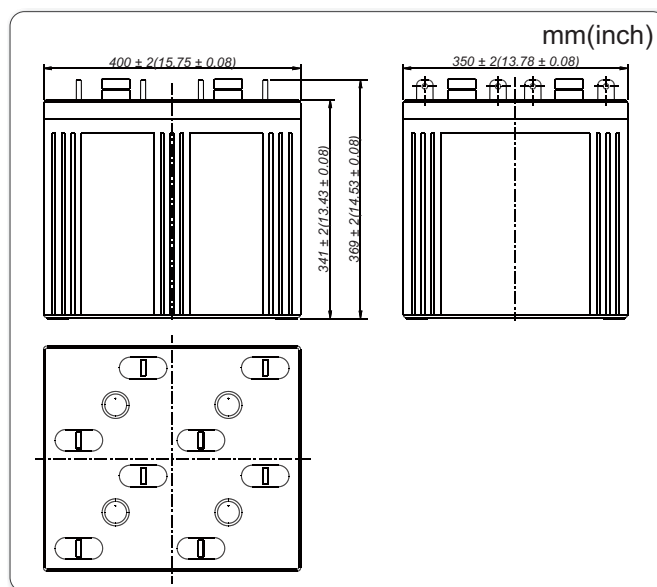

TERMINALS

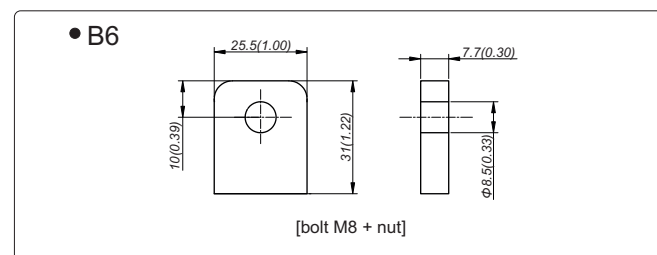

NO TRANSPORT RESTRICTED

Not restricted for air, surface and water transport. Classified as non-hazardous material (IATA/ICAO Special Provision A67, DOT-CFR Title 49 parts 171-189, IMDG amendment 27)

DISCHARGE CHARACTERISTICS

• Constant current (Current [A], 25°C / 77°F)

| F.V. V/cell | Discharge time | | | | | | | | | | |
|----------------|----------------|-------|-------|-------|-------|-------|-------|-------|-------|--------|-------|
| | 30 min | 1h | 2h | 3h | 4h | 5h | 6h | 8h | 10h | 12h | 20h |
| 1,85 | 1050,0 | 720,0 | 457,5 | 353,7 | 277,5 | 234,8 | 202,5 | 165,0 | 140,3 | 121,55 | 75,74 |
| 1,80 | 1170,0 | 795,0 | 495,0 | 375,0 | 306,0 | 255,0 | 217,5 | 181,5 | 150,0 | 128,75 | 80,25 |
| 1,75 | 1292,3 | 847,5 | 527,3 | 397,1 | 321,0 | 270,0 | 232,5 | 189,8 | 158,3 | 134,51 | 83,48 |
| 1,70 | 1432,5 | 909,0 | 549,8 | 413,8 | 329,3 | 279,0 | 240,0 | 196,5 | 164,3 | 138,24 | 85,88 |
| 1,65 | 1533,8 | 945,8 | 564,8 | 427,6 | 337,5 | 286,5 | 249,0 | 202,5 | 167,3 | 140,02 | 87,00 |
| 1,60 | 1612,5 | 969,8 | 581,3 | 436,8 | 343,5 | 291,0 | 251,3 | 206,3 | 168,8 | 141,33 | 87,23 |

• Constant power (Power [W/cell], 25°C / 77°F)

| F.V. V/cell | Discharge time | | | | | | | | | | |
|----------------|----------------|--------|--------|-------|-------|-------|-------|-------|-------|--------|--------|
| | 30 min | 1h | 2h | 3h | 4h | 5h | 6h | 8h | 10h | 12h | 20h |
| 1,85 | 1967,3 | 1350,0 | 868,5 | 676,4 | 525,8 | 453,0 | 403,5 | 333,8 | 279,0 | 241,80 | 150,66 |
| 1,80 | 2182,5 | 1485,0 | 937,5 | 716,6 | 579,0 | 493,5 | 429,8 | 357,0 | 295,3 | 253,47 | 157,99 |
| 1,75 | 2391,0 | 1575,0 | 993,8 | 754,5 | 606,6 | 516,0 | 448,5 | 368,3 | 308,4 | 262,16 | 162,69 |
| 1,70 | 2625,0 | 1680,0 | 1027,5 | 780,2 | 618,8 | 528,8 | 459,8 | 375,8 | 318,8 | 268,28 | 165,38 |
| 1,65 | 2820,0 | 1732,5 | 1042,5 | 796,1 | 631,5 | 536,3 | 468,8 | 382,5 | 323,3 | 272,07 | 166,77 |
| 1,60 | 2876,3 | 1747,5 | 1057,5 | 803,7 | 639,0 | 543,8 | 471,0 | 387,0 | 326,3 | 273,33 | 167,25 |

F.V. - Final voltage

Cell life characteristics of standby use

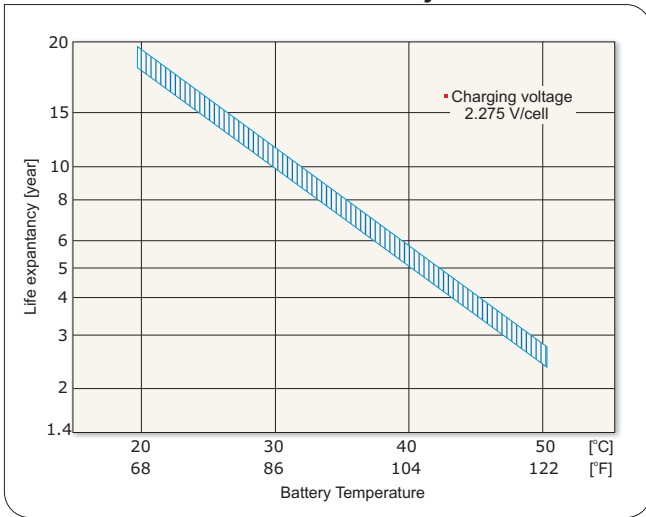

Cell life characteristics of cycle use

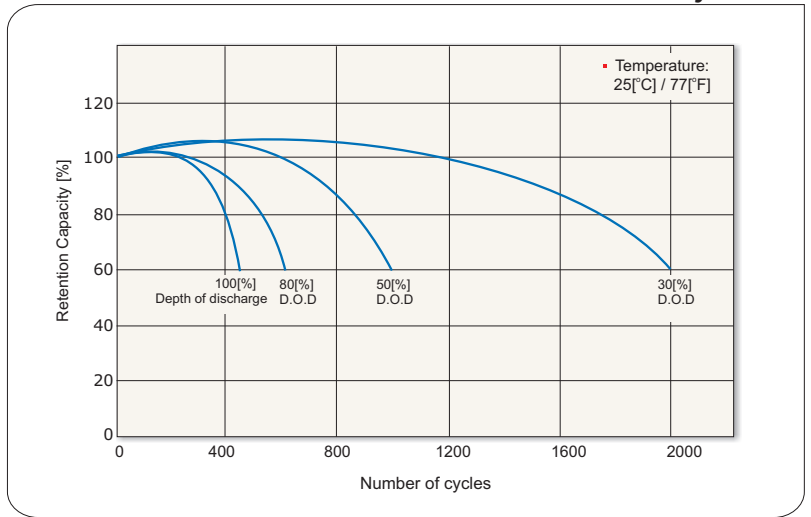

Cell discharge characteristics

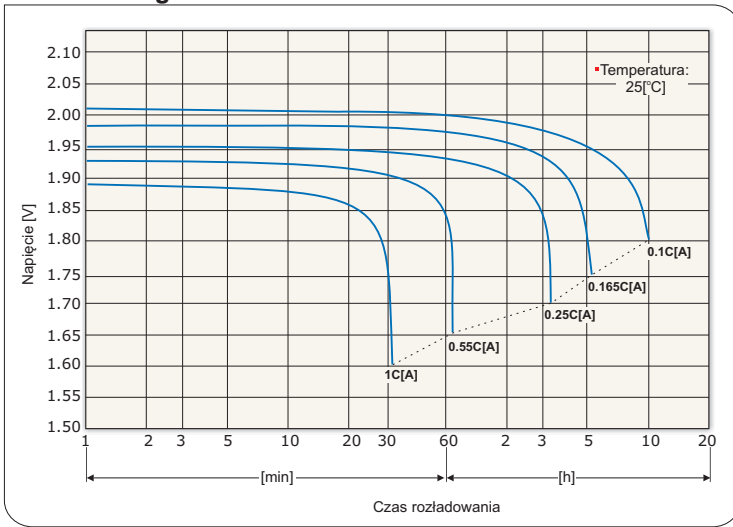

Cell self discharge characteristics

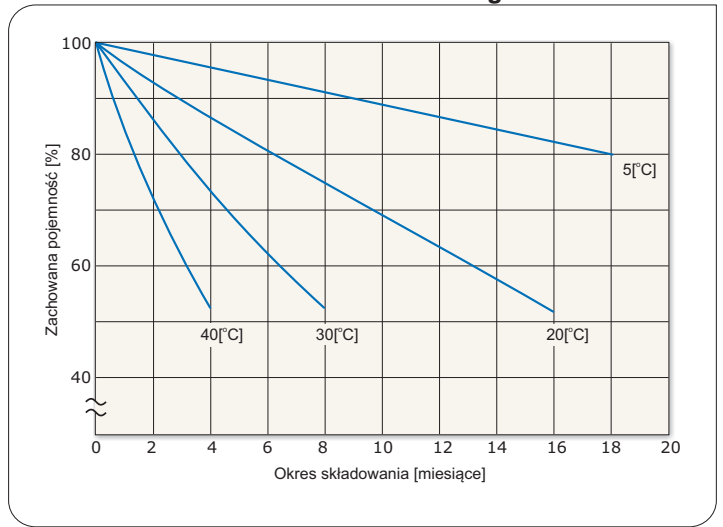

Cell charging characteristics for the standby use

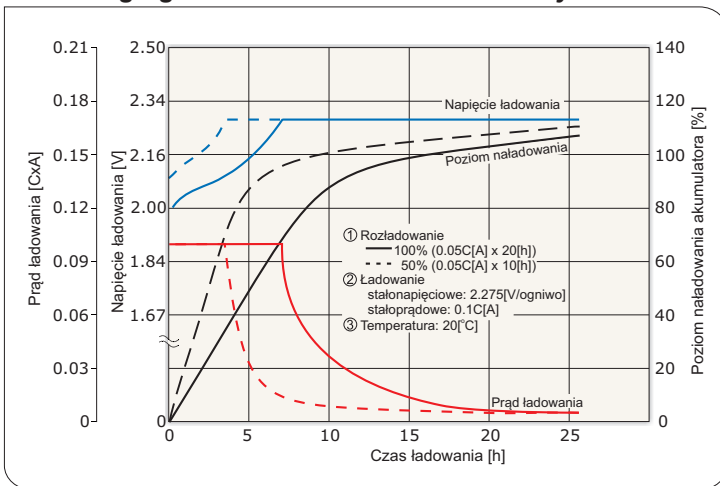

Cell charging characteristics for the cycle use

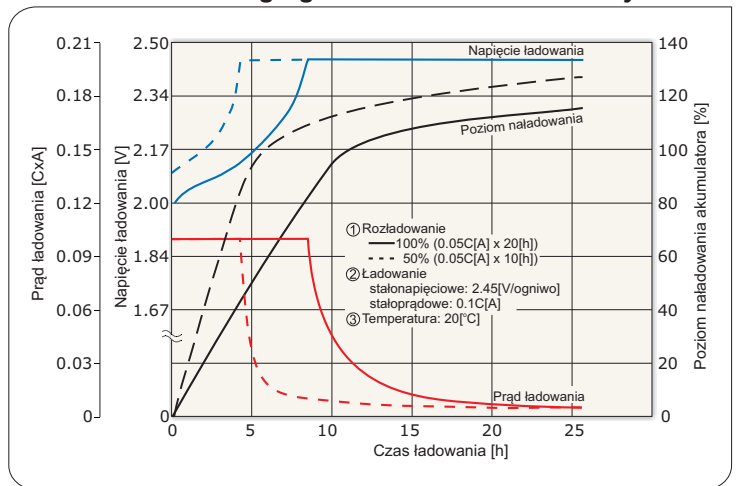

Cell discharge current and final discharge voltage

| Discharge current [A] | $0.2C > I$ | $0.2C \leq I < 0.5C$ | $0.5C \leq I < 1.0C$ | $1.0C \leq I$ |
|----------------------------------|------------|----------------------|----------------------|---------------|
| Final discharge voltage [V/cell] | 1.75 | 1.70 | 1.65 | 1.60 |

*) C - Capacity

