

ACUMAX® sealed maintenance-free lead-acid battery AML series



AML 100-12

- uninterruptible power supplies
- telecom power supply systems
- telecommunication PABX
- power station
- fire and security systems
- solar powered systems
- emergency lighting systems
- cable TV

Technical data

Nominal voltage	12 V
Nominal capacity	100 Ah/ C ₂₀
Design life	8 years @ 25°C 10-12 years @ 20°C according to Eurobat, Long Life group
Weight	~ 31.3 kg
Dimensions	
Height	220 mm
Length	330 mm
Width	172 mm
Internal resistance	≤ 4.0 mΩ
Charging voltage @ 25°C	
Standby use	13.65 V ± 0.18 V
Cykle use	14.70 V ± 0.30 V
Charging current	
Recommended	10 A
Maximum	30 A
Max. discharge current (5s)	1200 A
Container material	
Standard	ABS UL 94-HB
Optional (Flame-retardant)	ABS UL 94-V0

Battery approved for transportation by air, sea or land. Classified as non-hazardous material: IATA/ICAO Special Provision A67, DOT-CFR Title 49 parts 171-189, IMDG amendment 27.

Constant current discharge (Current [A], 25 [°C] / 77 [°F])

U _f [V/cell]	Discharge time								
	10 min	15 min	20min	30 min	1h	3h	5h	10h	20h
1,80	199	168	146	114	64,3	28,1	18,1	10,2	5,16
1,75	221	182	161	120	68,0	28,6	18,5	10,3	5,22
1,70	238	194	165	121	70,4	29,5	18,7	10,4	5,43

Constant power discharge (Power [W/cell], 25 [°C] / 77 [°F])

U _f [V/cell]	Discharge time								
	10 min	15 min	20min	30 min	1h	3h	5h	10h	20h
1,75	397	345	299	230	140	55,2	37,3	19,3	10,1
1,70	414	358	303	234	141	55,6	37,7	19,7	10,4
1,65	433	373	316	235	143	56,7	38,0	20,0	10,5

U_f - Final voltage



Pb

Pb

ACUMAX®

Sealed, maintenance free, lead-acid **ACUMAX®** batteries with a **10 - 12** years designed lifetime are made in **AGM** technology - electrolyte is absorbed in highly porous fiber glass separators placed between the plates. They use a gas recombination cycle which prevents electrolyte loss and allows the batteries to be used in rooms without forced ventilation, that are occupied by people. One-way, self-regulating pressure relief valves prevent the case from blowing up, by preventing excessive buildup of pressure in the cells.

Main applications

- marine
- golf-carts, wheelchairs
- mobile and portable equipment
- medical equipment

Discharge characteristics

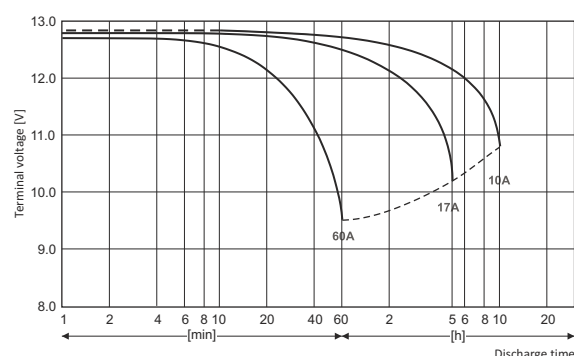

Dimensions

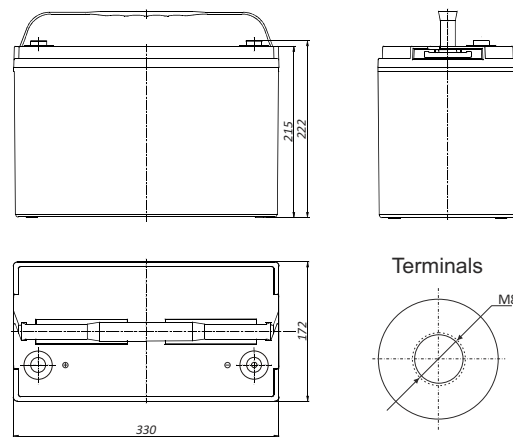

Tolerance: +/- 2mm;